

# **A66 Northern Trans-Pennine Project**

**Scheme 06: Appleby to Brough**

**TR010062**

## **2.5 General Arrangement Drawings**

**APFP Regulations 5(2)(o)**

**Planning Act 2008**

**Infrastructure Planning (Applications: Prescribed Forms and  
Procedure) Regulations 2009**

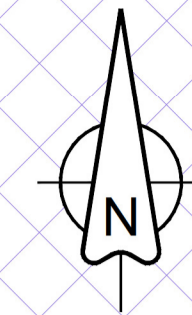
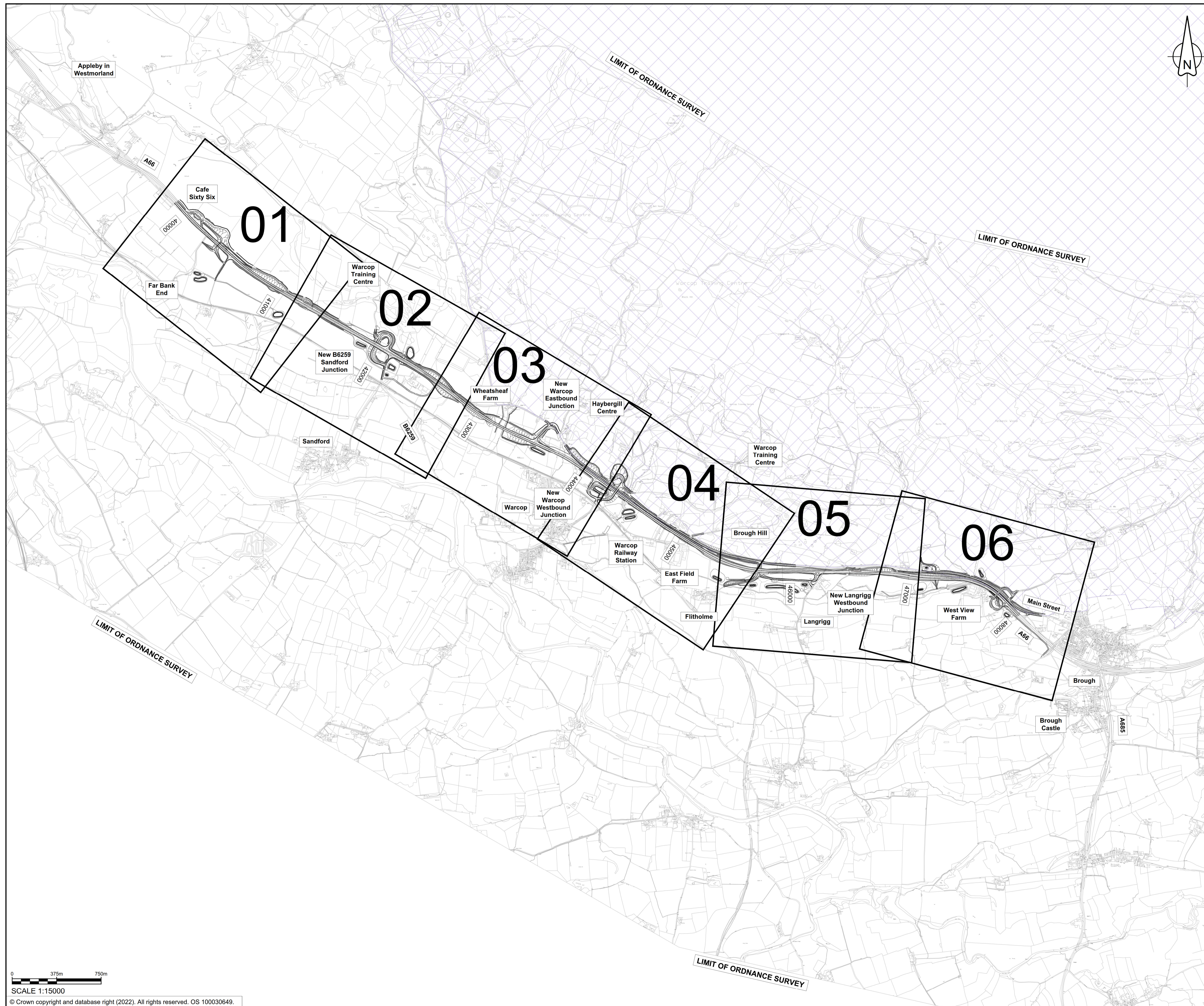

**June 2022**



**NOTES**

- ALL DIMENSIONS ARE IN METRES UNLESS NOTED OTHERWISE.

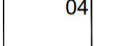
**KEY**

-  THE SCHEME (SHOWN FOR ILLUSTRATIVE PURPOSES ONLY)
-  SHEET USED AS PART OF THIS DRAWING SERIES
-  AREA OF OUTSTANDING NATURAL BEAUTY (AONB)
-  CHAINAGE (MEASURED DISTANCE ALONG THE SCHEME LENGTH)

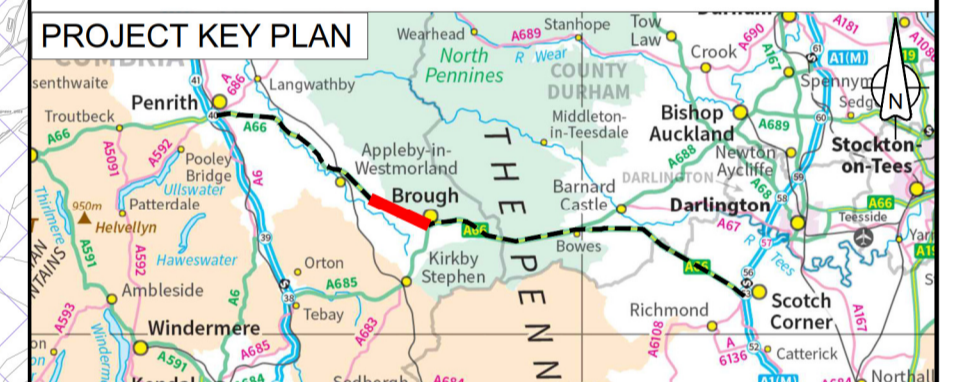

Revision	For DCO Submission				
	MVAG	MVAG	PBUN	SBAG	SBAG
	26/05/22	28/05/22	06/06/22	06/06/22	06/06/22
Revision details					
Created	Checked	Reviewed	Approved	Authorised	
dd/mm/yy	dd/mm/yy	dd/mm/yy	dd/mm/yy	dd/mm/yy	

Purpose: DCO APPLICATION

PINS Reference Number: TR010062/APP/2.5

Client:  
3 Piccadilly Place  
Manchester  
M1 3BN



Project Name / Scheme Name:  
**A66 Northern Trans-Pennine Project  
Scheme 06  
Appleby to Brough**

Drawing Title:  
**General Arrangement Drawings  
Regulation 5(2)(o)  
Key Plan**

Project Ref. No.	Stage	Scale	@ A1
---	PCF3	As Shown	
		Dimensions	M

Drawing Number	Project	Originator	Volume
HE565627 - AMY - HAC -			
S06	-DR-CH-	400000	
Location	Type	Role	Number

Suitability	Suitability Description	Revision
A	Approved for Stage Complete	C01

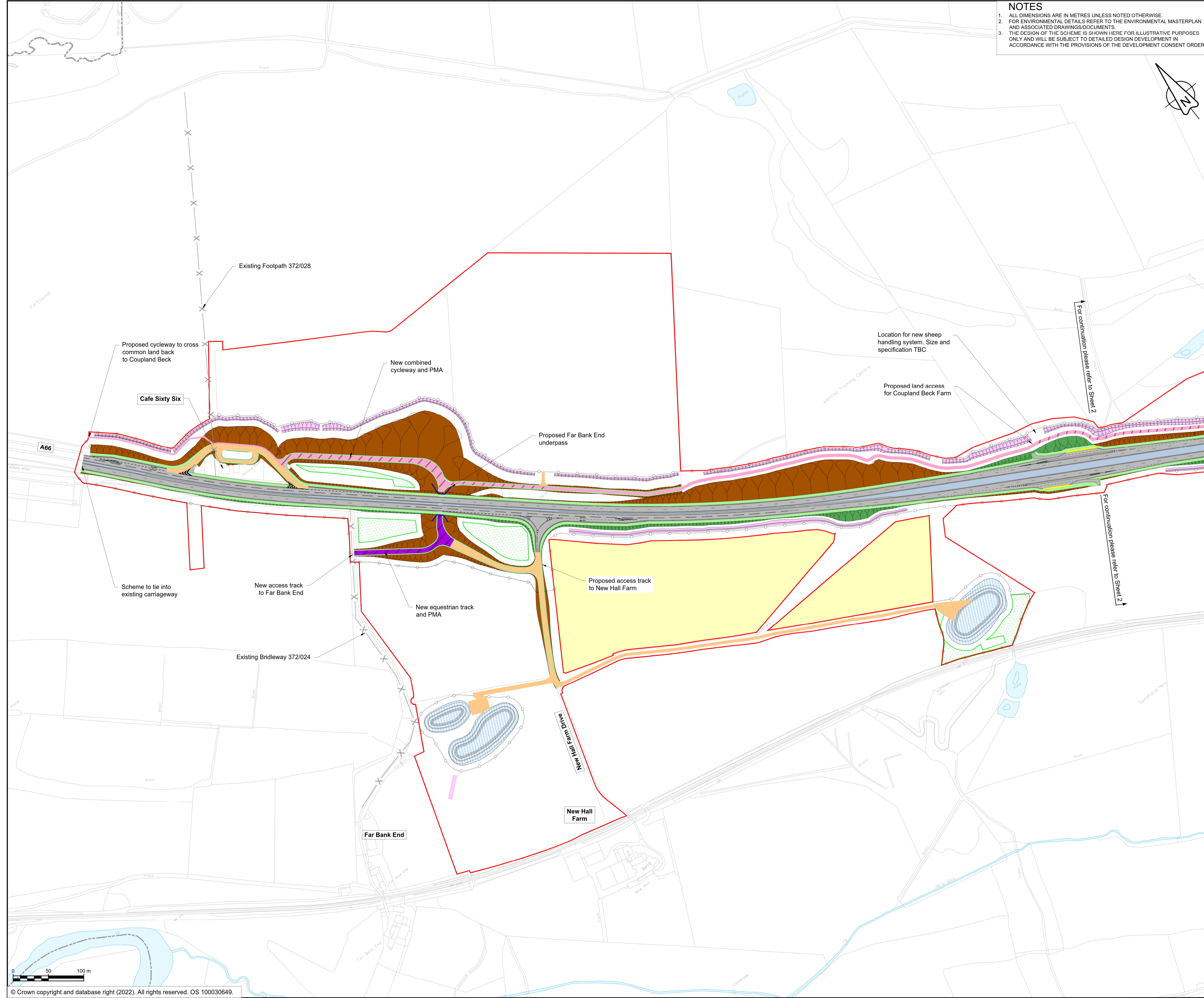

**NOTES**

1. ALL DIMENSIONS ARE IN METRES UNLESS NOTED OTHERWISE.
2. FOR ENVIRONMENTAL DETAILS REFER TO THE ENVIRONMENTAL MASTERPLAN AND ASSOCIATED DRAWINGS/DOCUMENTS.
3. THE DESIGN OF THE SCHEME IS SHOWN HERE FOR ILLUSTRATIVE PURPOSES ONLY AND WILL BE SUBJECT TO DETAILED DESIGN DEVELOPMENT IN ACCORDANCE WITH THE PROVISIONS OF THE DEVELOPMENT CONSENT ORDER.

- KEY**
- ORDER LIMITS
  - AREA EXCLUDED FROM ORDER LIMITS
  - AREA OF OUTSTANDING NATURAL BEAUTY (AONB)
  - EXISTING WATERCOURSE
  - PROPOSED HIGHWAY BOUNDARY
  - PARISH BOUNDARY
  - PROPOSED EQUESTRIAN TRACK AND PRIVATE MEANS OF ACCESS
  - PROPOSED BRIDLEWAY AND PRIVATE MEANS OF ACCESS
  - PROPOSED BRIDLEWAY
  - PROPOSED FOOTPATH AND PRIVATE MEANS OF ACCESS
  - PROPOSED FOOTPATH
  - PROPOSED SHARED CYCLEWAY AND PRIVATE MEANS OF ACCESS
  - PROPOSED SHARED CYCLEWAY
  - PROPOSED FOOTWAY AND PRIVATE MEANS OF ACCESS
  - PROPOSED FOOTWAY
  - PROPOSED PRIVATE MEANS OF ACCESS
  - EXISTING PUBLIC RIGHT OF WAY
  - PROPOSED EARTHWORKS (EMBANKMENTS)
  - PROPOSED EARTHWORKS (CUTTING)
  - PROPOSED DITCH
  - PROPOSED VERGE
  - PROPOSED CENTRAL RESERVE
  - PROPOSED HIGHWAY STRUCTURE
  - PROPOSED CARRIAGEWAY
  - PROPOSED DRAINAGE TREATMENT AREA
  - PROPOSED LANDSCAPE REPROFILING
  - PROPOSED SITE COMPOUND
  - PROPOSED VARIABLE MESSAGE SIGN
  - NEW MOD COMPOUND

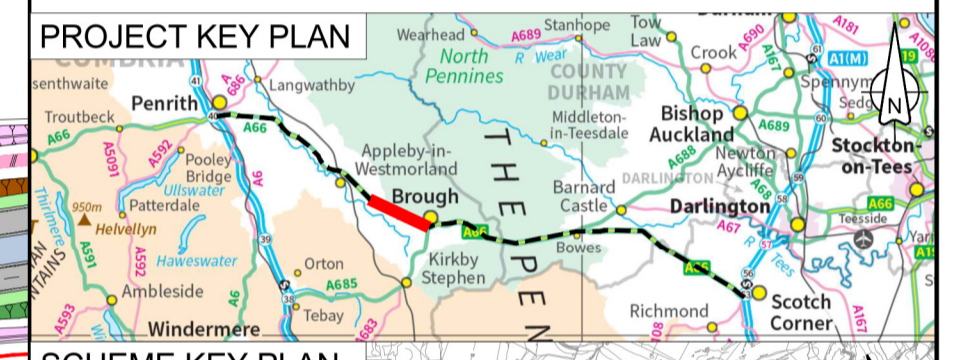

P04	For DCO Submission				
	MVAG	MVAG	PBUN	SBAG	SBAG
	08/06/22	08/06/22	08/06/22	08/06/22	08/06/22
Revision	Revision details				
	Created	Checked	Reviewed	Approved	Authorised
	dd/mm/yy	dd/mm/yy	dd/mm/yy	dd/mm/yy	dd/mm/yy

Purpose: DCO APPLICATION

PINS Reference Number: TR010062/APP/2.5

Client: 3 Piccadilly Place, Manchester, M1 3BN

Project Name / Scheme Name: A66 Northern Trans-Pennine Project Scheme 06 Appleby to Brough

Drawing Title: General Arrangement Drawings Regulation 5(2)(o) Sheet 1 of 6

Project Ref. No.	Stage	Scale	@ A1
---	PCF3	1:2500	
		Dimensions	M

Drawing Number	Project	Originator	Volume
HE565627	- AMY	- HAC	-
S06	- DR	- CH	- 400001
Location	Type	Role	Number

Suitability	Suitability Description	Revision
S1	Fit for Co-ordination	P04

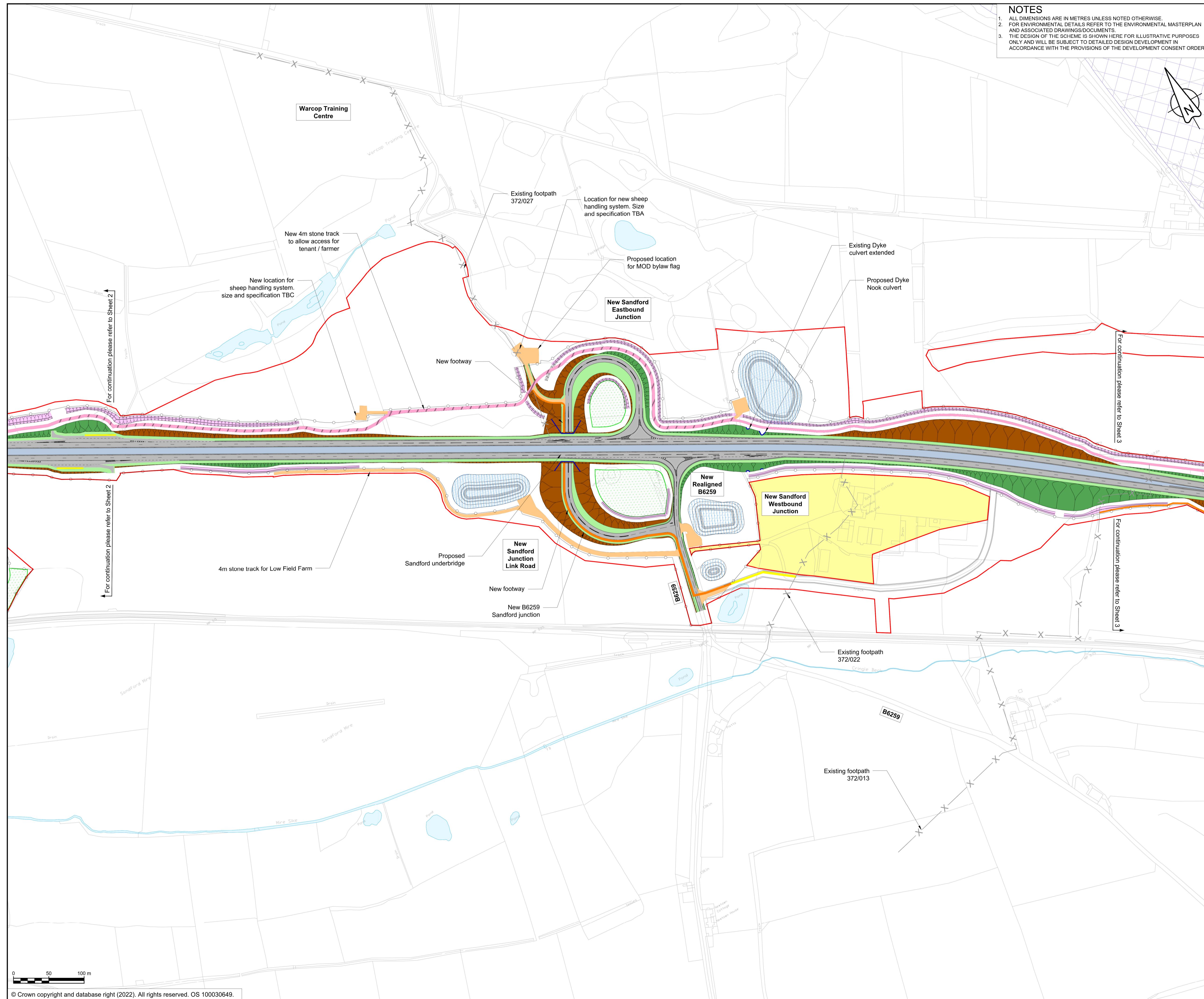

**NOTES**

1. ALL DIMENSIONS ARE IN METRES UNLESS NOTED OTHERWISE.
2. FOR ENVIRONMENTAL DETAILS REFER TO THE ENVIRONMENTAL MASTERPLAN AND ASSOCIATED DRAWINGS/DOCUMENTS.
3. THE DESIGN OF THE SCHEME IS SHOWN HERE FOR ILLUSTRATIVE PURPOSES ONLY AND WILL BE SUBJECT TO DETAILED DESIGN DEVELOPMENT IN ACCORDANCE WITH THE PROVISIONS OF THE DEVELOPMENT CONSENT ORDER.

**KEY**

- ORDER LIMITS
- AREA EXCLUDED FROM ORDER LIMITS
- AREA OF OUTSTANDING NATURAL BEAUTY (AONB)
- EXISTING WATERCOURSE
- PROPOSED HIGHWAY BOUNDARY
- PARISH BOUNDARY
- PROPOSED EQUESTRIAN TRACK AND PRIVATE MEANS OF ACCESS
- PROPOSED BRIDLEWAY AND PRIVATE MEANS OF ACCESS
- PROPOSED BRIDLEWAY
- PROPOSED FOOTPATH AND PRIVATE MEANS OF ACCESS
- PROPOSED FOOTPATH
- PROPOSED SHARED CYCLEWAY AND PRIVATE MEANS OF ACCESS
- PROPOSED SHARED CYCLEWAY
- PROPOSED FOOTWAY AND PRIVATE MEANS OF ACCESS
- PROPOSED FOOTWAY
- PROPOSED PRIVATE MEANS OF ACCESS
- EXISTING PUBLIC RIGHT OF WAY
- PROPOSED EARTHWORKS (EMBANKMENTS)
- PROPOSED EARTHWORKS (CUTTING)
- PROPOSED DITCH
- PROPOSED VERGE
- PROPOSED CENTRAL RESERVE
- PROPOSED HIGHWAY STRUCTURE
- PROPOSED CARRIAGEWAY
- PROPOSED DRAINAGE TREATMENT AREA
- PROPOSED LANDSCAPE REPROFILING
- PROPOSED SITE COMPOUND
- PROPOSED VARIABLE MESSAGE SIGN
- NEW MOD COMPOUND

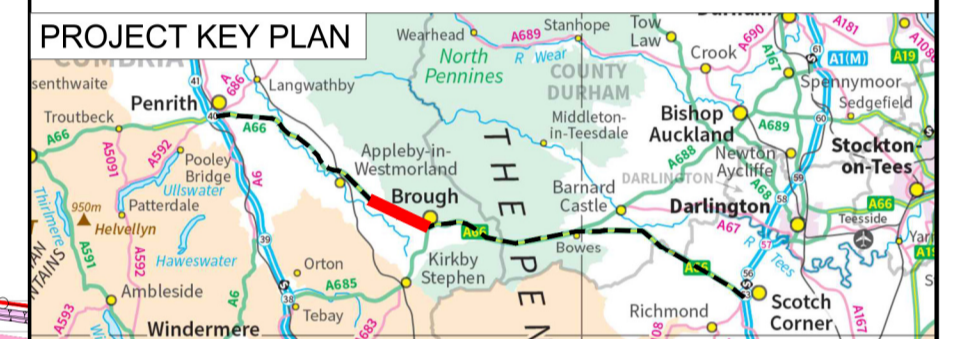

C01	For DCO Submission				
	MVAG	MVAG	PBUN	SBAG	SBAG
	31/05/22	31/05/22	07/06/22	07/06/22	07/06/22
Revision	Revision details				
	Created	Checked	Reviewed	Approved	Authorised
	dd/mm/yy	dd/mm/yy	dd/mm/yy	dd/mm/yy	dd/mm/yy

Purpose	DCO APPLICATION
PINS Reference Number	TR010062/APP/2.5

Client  
3 Piccadilly Place  
Manchester  
M1 3BN

Project Name / Scheme Name  
**A66 Northern Trans-Pennine Project  
Scheme 06  
Appleby to Brough**

Drawing Title  
**General Arrangement Drawings  
Regulation 5(2)(o)  
Sheet 2 of 6**

Project Ref. No.	Stage	Scale	@ A1
---	PCF3	1:2500	
		Dimensions	M

Drawing Number	Project	Originator	Volume
HE565627 - AMY - HAC -			
S06	-DR-CH-	400002	
Location	Type	Role	Number

Suitability	Suitability Description	Revision
A	Approved for Stage Complete	C01

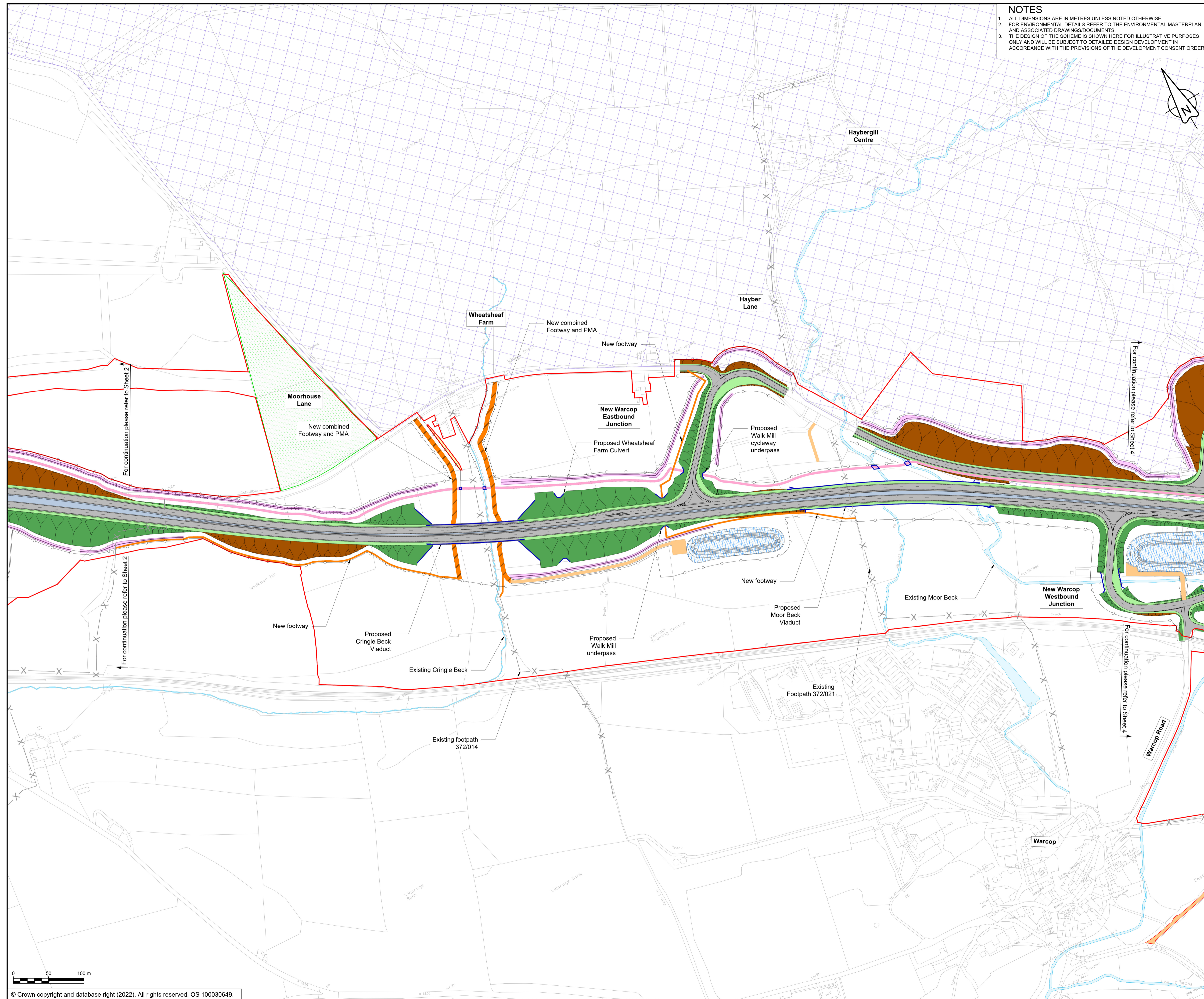

**NOTES**  
 1. ALL DIMENSIONS ARE IN METRES UNLESS NOTED OTHERWISE.  
 2. FOR ENVIRONMENTAL DETAILS REFER TO THE ENVIRONMENTAL MASTERPLAN AND ASSOCIATED DRAWINGS/DOCUMENTS.  
 3. THE DESIGN OF THE SCHEME IS SHOWN HERE FOR ILLUSTRATIVE PURPOSES ONLY AND WILL BE SUBJECT TO DETAILED DESIGN DEVELOPMENT IN ACCORDANCE WITH THE PROVISIONS OF THE DEVELOPMENT CONSENT ORDER.

**KEY**

- ORDER LIMITS
- AREA EXCLUDED FROM ORDER LIMITS
- AREA OF OUTSTANDING NATURAL BEAUTY (AONB)
- EXISTING WATERCOURSE
- PROPOSED HIGHWAY BOUNDARY
- PARISH BOUNDARY
- PROPOSED EQUESTRIAN TRACK AND PRIVATE MEANS OF ACCESS
- PROPOSED BRIDLEWAY AND PRIVATE MEANS OF ACCESS
- PROPOSED BRIDLEWAY
- PROPOSED FOOTPATH AND PRIVATE MEANS OF ACCESS
- PROPOSED FOOTPATH
- PROPOSED SHARED CYCLEWAY AND PRIVATE MEANS OF ACCESS
- PROPOSED SHARED CYCLEWAY
- PROPOSED FOOTWAY AND PRIVATE MEANS OF ACCESS
- PROPOSED FOOTWAY
- PROPOSED PRIVATE MEANS OF ACCESS
- EXISTING PUBLIC RIGHT OF WAY
- PROPOSED EARTHWORKS (EMBANKMENTS)
- PROPOSED EARTHWORKS (CUTTING)
- PROPOSED DITCH
- PROPOSED VERGE
- PROPOSED CENTRAL RESERVE
- PROPOSED HIGHWAY STRUCTURE
- PROPOSED CARRIAGEWAY
- PROPOSED DRAINAGE TREATMENT AREA
- PROPOSED LANDSCAPE REPROFILING
- PROPOSED SITE COMPOUND
- PROPOSED VARIABLE MESSAGE SIGN
- NEW MOD COMPOUND

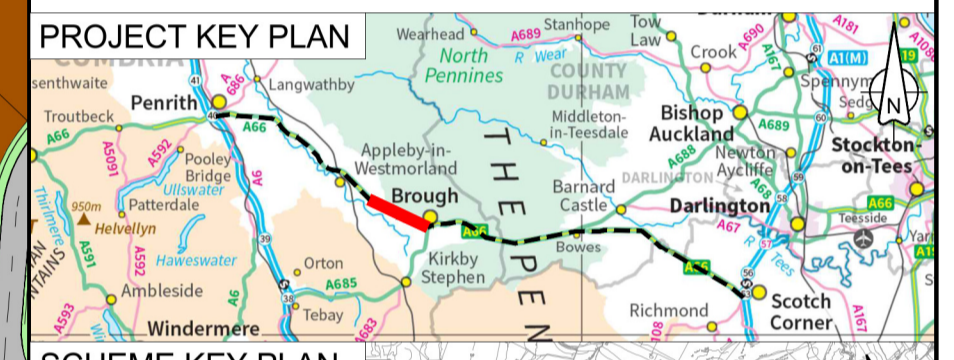

C01	For DCO Submission				
	MVAG	MVAG	PBUN	SBAG	SBAG
	31/05/22	31/05/22	07/06/22	07/06/22	07/06/22
Revision	Revision details				
	Created	Checked	Reviewed	Approved	Authorised
	dd/mm/yy	dd/mm/yy	dd/mm/yy	dd/mm/yy	dd/mm/yy

Purpose: **DCO APPLICATION**

PINS Reference Number: **TR010062/APP/2.5**

Client: **3 Piccadilly Place  
Manchester  
M1 3BN**

Project Name / Scheme Name: **A66 Northern Trans-Pennine Project  
Scheme 06  
Appley to Brough**

Drawing Title: **General Arrangement Drawings  
Regulation 5(2)(o)  
Sheet 3 of 6**

Project Ref. No.	Stage	Scale	@ A1
---	PCF3	1:2500	
		Dimensions	M

Drawing Number	Project	Originator	Volume
HE565627	- AMY	- HAC	-
S06	-DR-CH-	400003	
Location	Type	Role	Number

Suitability	Suitability Description	Revision
A	Approved for Stage Complete	C01

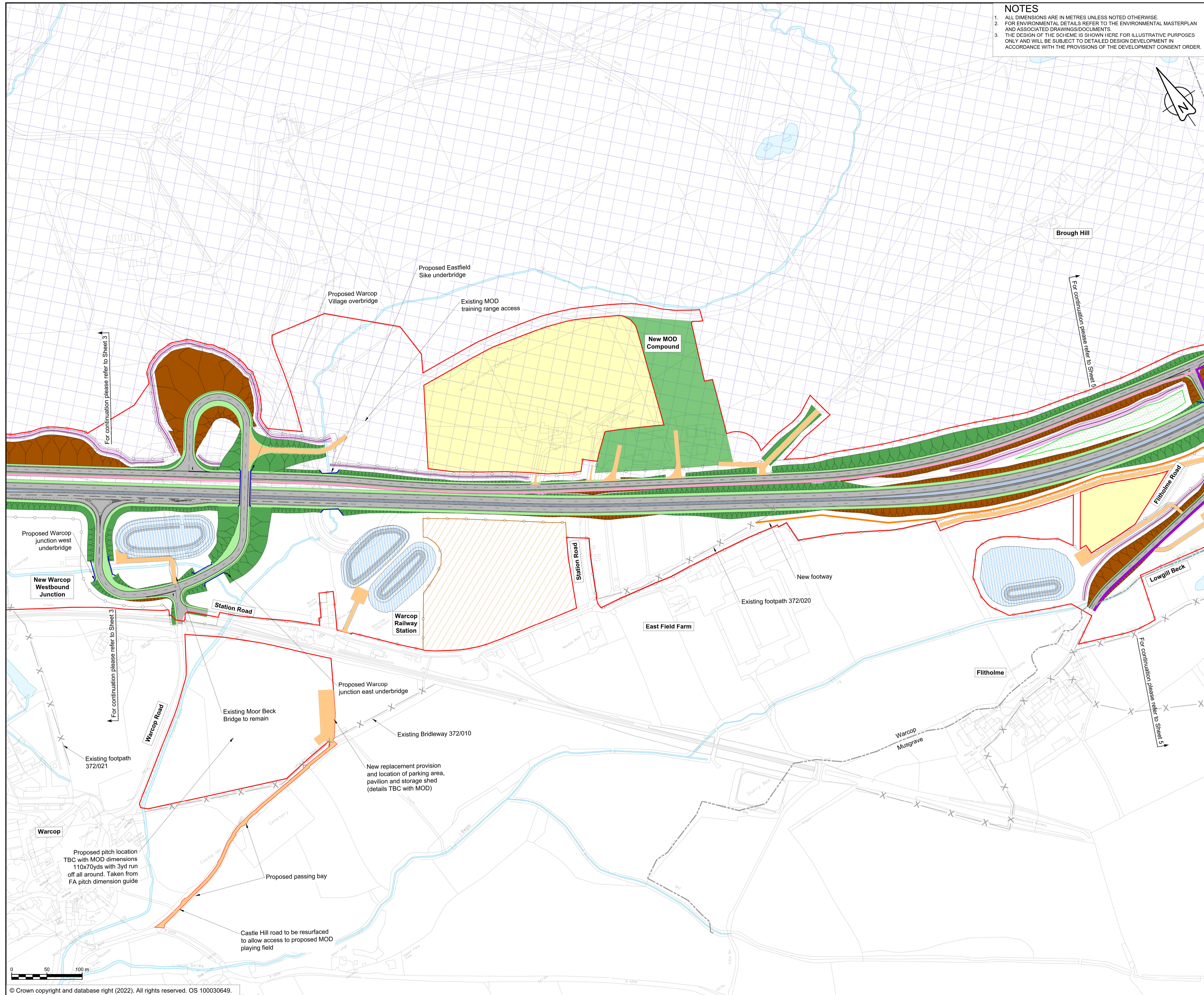

**NOTES**  
 1. ALL DIMENSIONS ARE IN METRES UNLESS NOTED OTHERWISE.  
 2. FOR ENVIRONMENTAL DETAILS REFER TO THE ENVIRONMENTAL MASTERPLAN AND ASSOCIATED DRAWINGS/DOCUMENTS.  
 3. THE DESIGN OF THE SCHEME IS SHOWN HERE FOR ILLUSTRATIVE PURPOSES ONLY AND WILL BE SUBJECT TO DETAILED DESIGN DEVELOPMENT IN ACCORDANCE WITH THE PROVISIONS OF THE DEVELOPMENT CONSENT ORDER.

**KEY**

- ORDER LIMITS
- AREA EXCLUDED FROM ORDER LIMITS
- AREA OF OUTSTANDING NATURAL BEAUTY (AONB)
- EXISTING WATERCOURSE
- PROPOSED HIGHWAY BOUNDARY
- PARISH BOUNDARY
- PROPOSED EQUESTRIAN TRACK AND PRIVATE MEANS OF ACCESS
- PROPOSED BRIDLEWAY AND PRIVATE MEANS OF ACCESS
- PROPOSED BRIDLEWAY
- PROPOSED FOOTPATH AND PRIVATE MEANS OF ACCESS
- PROPOSED FOOTPATH
- PROPOSED SHARED CYCLEWAY AND PRIVATE MEANS OF ACCESS
- PROPOSED SHARED CYCLEWAY
- PROPOSED FOOTWAY AND PRIVATE MEANS OF ACCESS
- PROPOSED FOOTWAY
- PROPOSED PRIVATE MEANS OF ACCESS
- EXISTING PUBLIC RIGHT OF WAY
- PROPOSED EARTHWORKS (EMBANKMENTS)
- PROPOSED EARTHWORKS (CUTTING)
- PROPOSED DITCH
- PROPOSED VERGE
- PROPOSED CENTRAL RESERVE
- PROPOSED HIGHWAY STRUCTURE
- PROPOSED CARRIAGEWAY
- PROPOSED DRAINAGE TREATMENT AREA
- PROPOSED LANDSCAPE REPROFILING
- PROPOSED SITE COMPOUND
- PROPOSED VARIABLE MESSAGE SIGN
- NEW MOD COMPOUND



C01	For DCO Submission				
	MVAG	MVAG	PBUN	SBAG	SBAG
	31/05/22	31/05/22	07/06/22	07/06/22	07/06/22
Revision details					
Revision	Created	Checked	Reviewed	Approved	Authorised
	dd/mm/yy	dd/mm/yy	dd/mm/yy	dd/mm/yy	dd/mm/yy

Purpose: **DCO APPLICATION**

PINS Reference Number: **TR010062/APP/2.5**

Client: **3 Piccadilly Place  
Manchester  
M1 3BN**

Project Name / Scheme Name: **A66 Northern Trans-Pennine Project  
Scheme 06  
Appleby to Brough**

Drawing Title: **General Arrangement Drawings  
Regulation 5(2)(o)  
Sheet 4 of 6**

Project Ref. No.	Stage	Scale:	@ A1
---	PCF3	1:2500	
		Dimensions:	M

Drawing Number	Project	Originator	Volume
HE565627 - AMY - HAC -			
S06	-DR-CH-	400004	
Location	Type	Role	Number

Suitability	Suitability Description	Revision
A	Approved for Stage Complete	C01

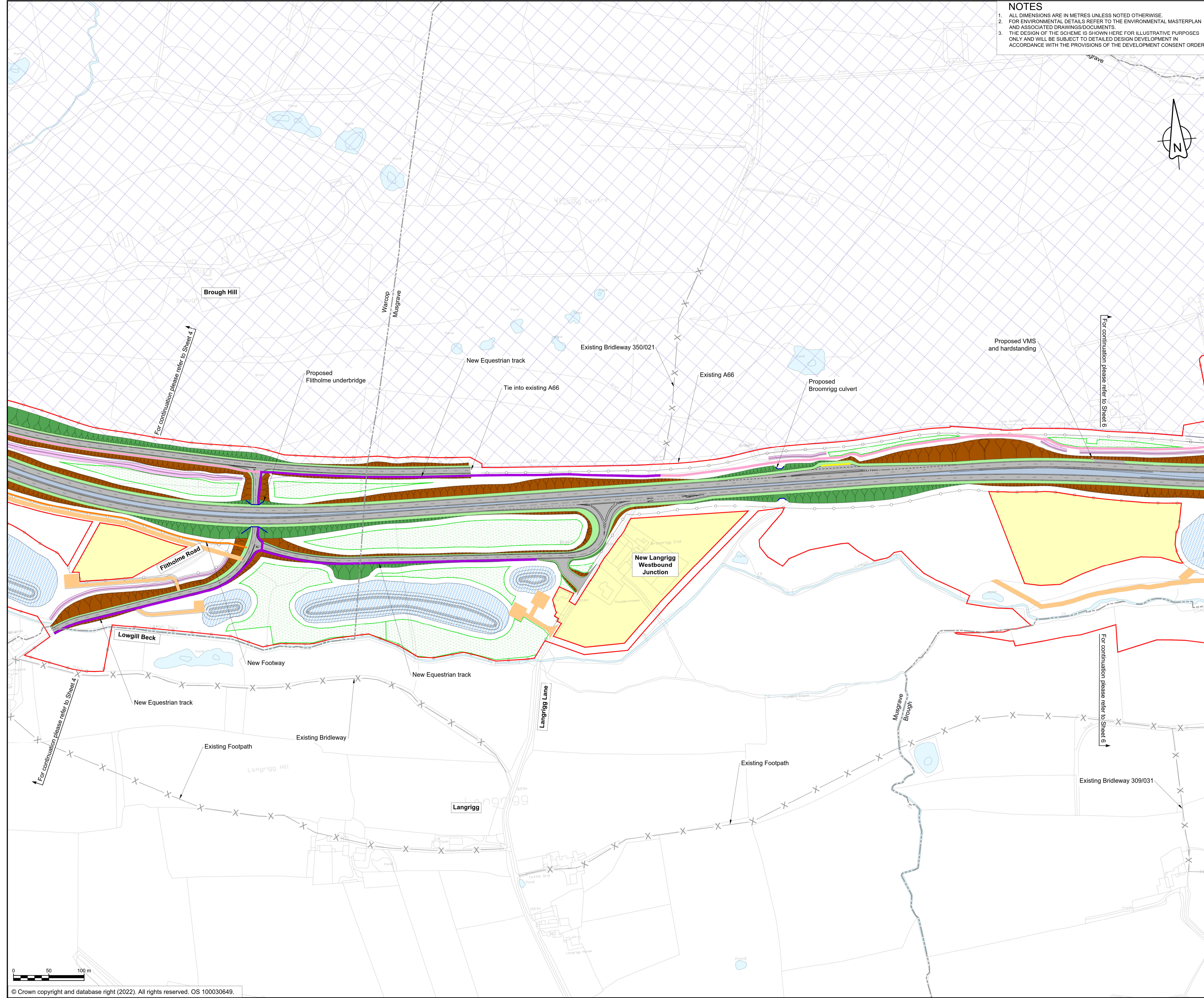

**NOTES**

1. ALL DIMENSIONS ARE IN METRES UNLESS NOTED OTHERWISE.
2. FOR ENVIRONMENTAL DETAILS REFER TO THE ENVIRONMENTAL MASTERPLAN AND ASSOCIATED DRAWINGS/DOCUMENTS.
3. THE DESIGN OF THE SCHEME IS SHOWN HERE FOR ILLUSTRATIVE PURPOSES ONLY AND WILL BE SUBJECT TO DETAILED DESIGN DEVELOPMENT IN ACCORDANCE WITH THE PROVISIONS OF THE DEVELOPMENT CONSENT ORDER.

**KEY**

- ORDER LIMITS
- AREA EXCLUDED FROM ORDER LIMITS
- AREA OF OUTSTANDING NATURAL BEAUTY (AONB)
- EXISTING WATERCOURSE
- PROPOSED HIGHWAY BOUNDARY
- PARISH BOUNDARY
- PROPOSED EQUESTRIAN TRACK AND PRIVATE MEANS OF ACCESS
- PROPOSED BRIDLEWAY AND PRIVATE MEANS OF ACCESS
- PROPOSED BRIDLEWAY
- PROPOSED FOOTPATH AND PRIVATE MEANS OF ACCESS
- PROPOSED FOOTPATH
- PROPOSED SHARED CYCLEWAY AND PRIVATE MEANS OF ACCESS
- PROPOSED SHARED CYCLEWAY
- PROPOSED FOOTWAY AND PRIVATE MEANS OF ACCESS
- PROPOSED FOOTWAY
- PROPOSED PRIVATE MEANS OF ACCESS
- EXISTING PUBLIC RIGHT OF WAY
- PROPOSED EARTHWORKS (EMBANKMENTS)
- PROPOSED EARTHWORKS (CUTTING)
- PROPOSED DITCH
- PROPOSED VERGE
- PROPOSED CENTRAL RESERVE
- PROPOSED HIGHWAY STRUCTURE
- PROPOSED CARRIAGEWAY
- PROPOSED DRAINAGE TREATMENT AREA
- PROPOSED LANDSCAPE REPROFILING
- PROPOSED SITE COMPOUND
- PROPOSED VARIABLE MESSAGE SIGN
- NEW MOD COMPOUND

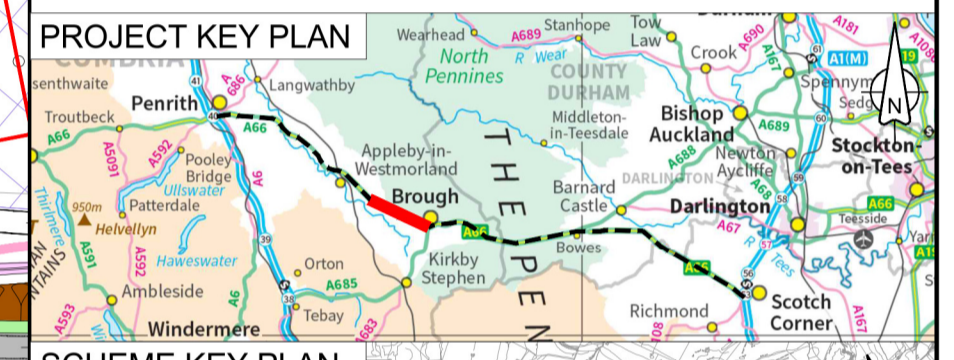

C02	For DCO Submission				
	MVAG	MVAG	PBUN	SBAG	SBAG
	09/06/22	09/06/22	09/06/22	09/06/22	09/06/22
Revision	Revision details				
	Created	Checked	Reviewed	Approved	Authorised
	dd/mm/yy	dd/mm/yy	dd/mm/yy	dd/mm/yy	dd/mm/yy

Purpose: DCO APPLICATION

PINS Reference Number: TR010062/APP/2.5

Client: 3 Piccadilly Place, Manchester, M1 3BN

Project Name / Scheme Name: A66 Northern Trans-Pennine Project Scheme 06 Appleby to Brough

Drawing Title: General Arrangement Drawings Regulation 5(2)(o) Sheet 5 of 6

Project Ref. No.	Stage	Scale	@ A1
---	PCF3	1:2500	
		Dimensions	M

Drawing Number	Project	Originator	Volume
HE565627	- AMY	- HAC	-
S06	- DR	- CH	- 400005
Location	Type	Role	Number

Suitability	Suitability Description	Revision
A	Approved for Stage Complete	C02

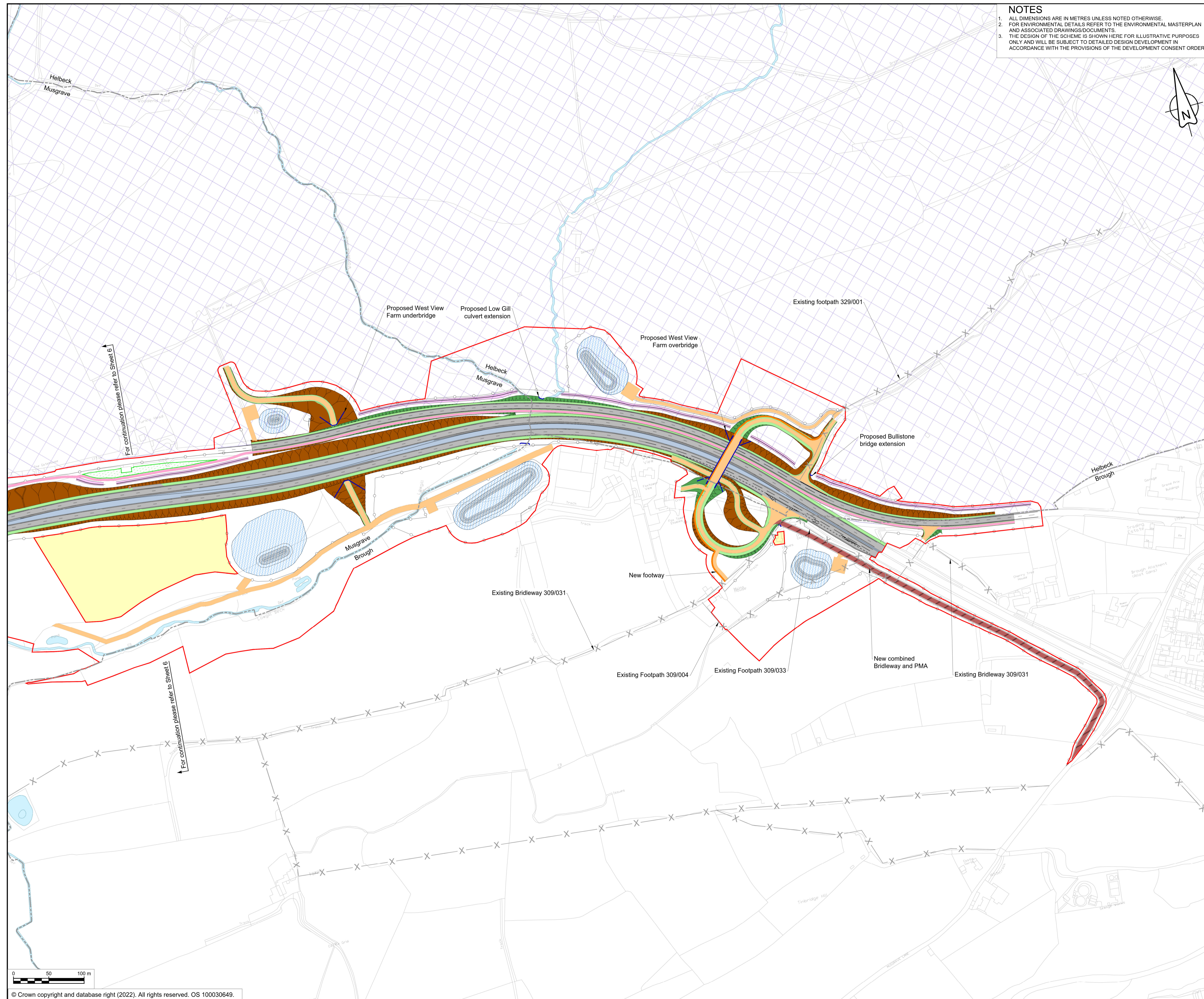

**NOTES**

1. ALL DIMENSIONS ARE IN METRES UNLESS NOTED OTHERWISE.
2. FOR ENVIRONMENTAL DETAILS REFER TO THE ENVIRONMENTAL MASTERPLAN AND ASSOCIATED DRAWINGS/DOCUMENTS.
3. THE DESIGN OF THE SCHEME IS SHOWN HERE FOR ILLUSTRATIVE PURPOSES ONLY AND WILL BE SUBJECT TO DETAILED DESIGN DEVELOPMENT IN ACCORDANCE WITH THE PROVISIONS OF THE DEVELOPMENT CONSENT ORDER.

**KEY**

- ORDER LIMITS
- AREA EXCLUDED FROM ORDER LIMITS
- AREA OF OUTSTANDING NATURAL BEAUTY (AONB)
- EXISTING WATERCOURSE
- PROPOSED HIGHWAY BOUNDARY
- PARISH BOUNDARY
- PROPOSED EQUESTRIAN TRACK AND PRIVATE MEANS OF ACCESS
- PROPOSED BRIDLEWAY AND PRIVATE MEANS OF ACCESS
- PROPOSED BRIDLEWAY
- PROPOSED FOOTPATH AND PRIVATE MEANS OF ACCESS
- PROPOSED FOOTPATH
- PROPOSED SHARED CYCLEWAY AND PRIVATE MEANS OF ACCESS
- PROPOSED SHARED CYCLEWAY
- PROPOSED FOOTWAY AND PRIVATE MEANS OF ACCESS
- PROPOSED FOOTWAY
- PROPOSED PRIVATE MEANS OF ACCESS
- EXISTING PUBLIC RIGHT OF WAY
- PROPOSED EARTHWORKS (EMBANKMENTS)
- PROPOSED EARTHWORKS (CUTTING)
- PROPOSED DITCH
- PROPOSED VERGE
- PROPOSED CENTRAL RESERVE
- PROPOSED HIGHWAY STRUCTURE
- PROPOSED CARRIAGEWAY
- PROPOSED DRAINAGE TREATMENT AREA
- PROPOSED LANDSCAPE REPROFILING
- PROPOSED SITE COMPOUND
- PROPOSED VARIABLE MESSAGE SIGN
- NEW MOD COMPOUND

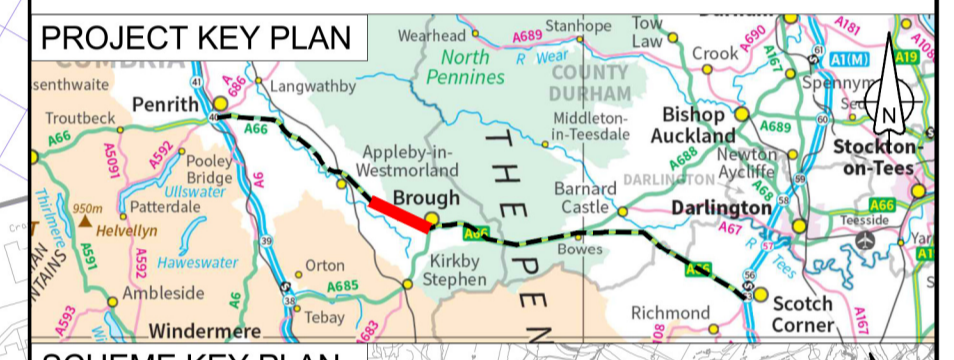

C01	For DCO Submission				
	MVAG	MVAG	PBUN	SBAG	SBAG
	31/05/22	31/05/22	06/06/22	07/06/22	07/06/22
Revision	Revision details				
	Created	Checked	Reviewed	Approved	Authorised
	dd/mm/yy	dd/mm/yy	dd/mm/yy	dd/mm/yy	dd/mm/yy

Purpose: DCO APPLICATION

PINS Reference Number: TR010062/APP/2.5

Client:  
3 Piccadilly Place  
Manchester  
M1 3BN

Project Name / Scheme Name:  
**A66 Northern Trans-Pennine Project  
Scheme 06  
Appleby to Brough**

Drawing Title:  
**General Arrangement Drawings  
Regulation 5(2)(o)  
Sheet 6 of 6**

Project Ref. No.	Stage	Scale	@ A1
---	PCF3	1:2500	
		Dimensions	M

Drawing Number	Project	Originator	Volume
HE565627	- AMY	- HAC	-
S06	-DR-CH-	400006	
Location	Type	Role	Number

Suitability	Suitability Description	Revision
A	Approved for Stage Complete	C01